

S:\01 Jobs\11400 - 11499\11467 Structures_Walker St and Caldwell St_East Lismore\05 Drawings\01 Civil\01 Current\11467_SMP_2023-07-18.dwg, 19/07/2023 9:29:52 AM, AutoCAD PDF (General Documentation).pc3

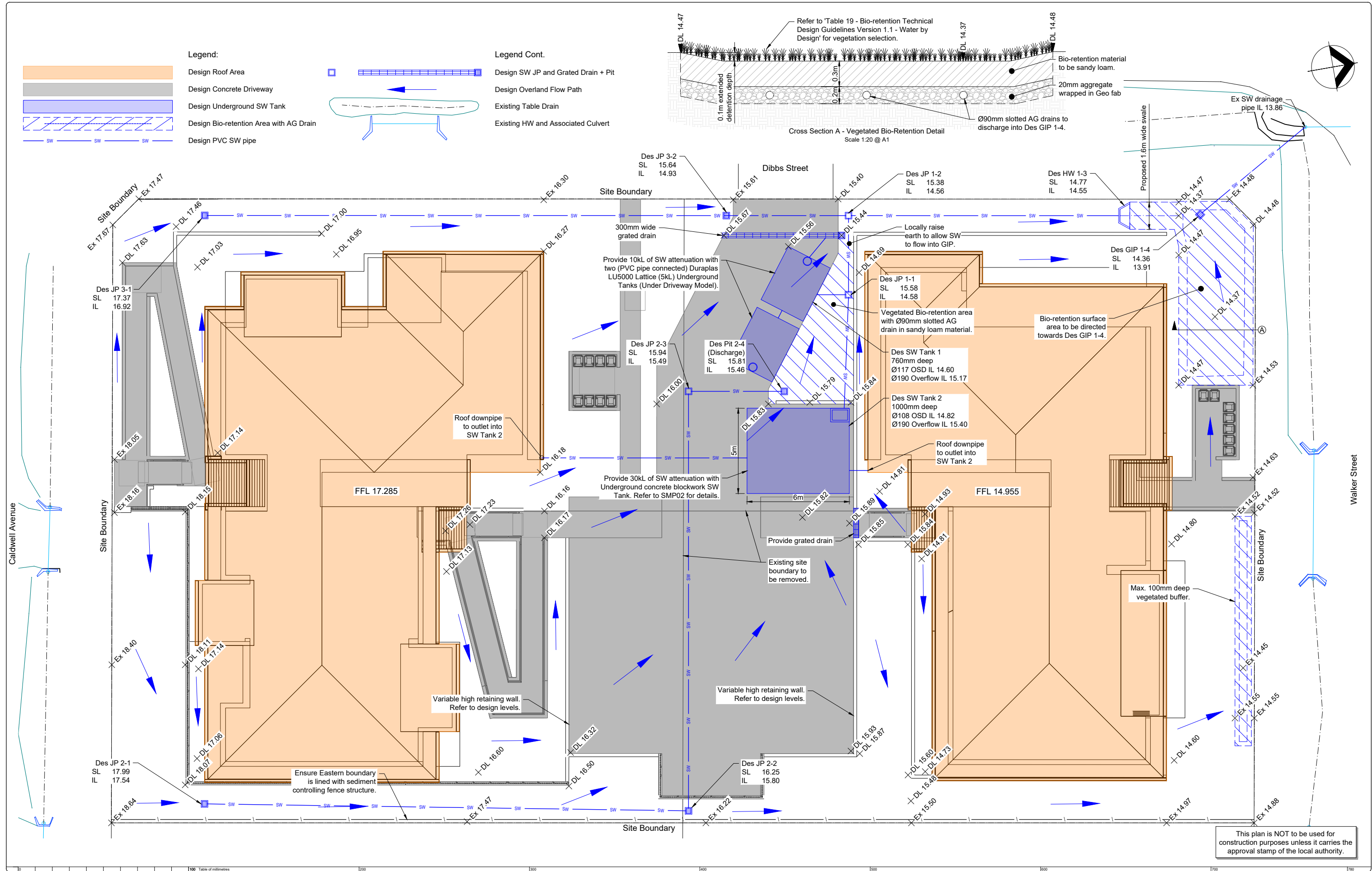

Issue	Date	Description	App'd
D	18/07/2023	Surface drainage structures and Sediment Fence	EMR
C	26/06/2023	SW Tank 1 Specification & Manhole inclusion	EMR
B	22/05/2023	Amended to suit LAHC comments	EMR
A	24/04/2023	Original Issue	RB

Client:



Level 4, 4 Parramatta Square,
Parramatta, NSW, 2150

Project:

1-3 Walker Street & 2-4 Caldwell Avenue

East Lismore, NSW 2480

Title:

**Stormwater Management Plan
Site Layout & Vegetated
Bio-Retention Detail**

Do not scale drawing. Use written dimensions only
This plan is copyright © All rights reserved.

ARDILL PAYNE
ENGINEERS PLANNERS SURVEYORS
ENVIRONMENTAL PROJECT MANAGEMENT

BALLINA 45 River Street Ph. 02 6686 3280
GUNNEDAH 285 Conadilly Street Ph. 02 6742 9955
A.B.N. 51 808 558 977 e-mail: info@ardillpayne.com.au

Design	RB/EMR	Scale	1:100 @ A1, 1:200 @ A3
Drawn	EMR		
Checked	RB	Datum	
Approved	RB	Drafting File	11467_SMP_2023-07-18.dwg
Date	24/04/2023	Design File	
Job No.	11467	Dwg No.	SMP01
		Issue	D

S:\01 Jobs\11400 - 11499\11467 Structures_Walker St and Caldwell St_East Lismore\05 Drawings\01 Civil\01 Current\11467_SMP_2023-07-18.dwg, 19/07/2023 9:29:57 AM, AutoCAD PDF (General Documentation).pc3

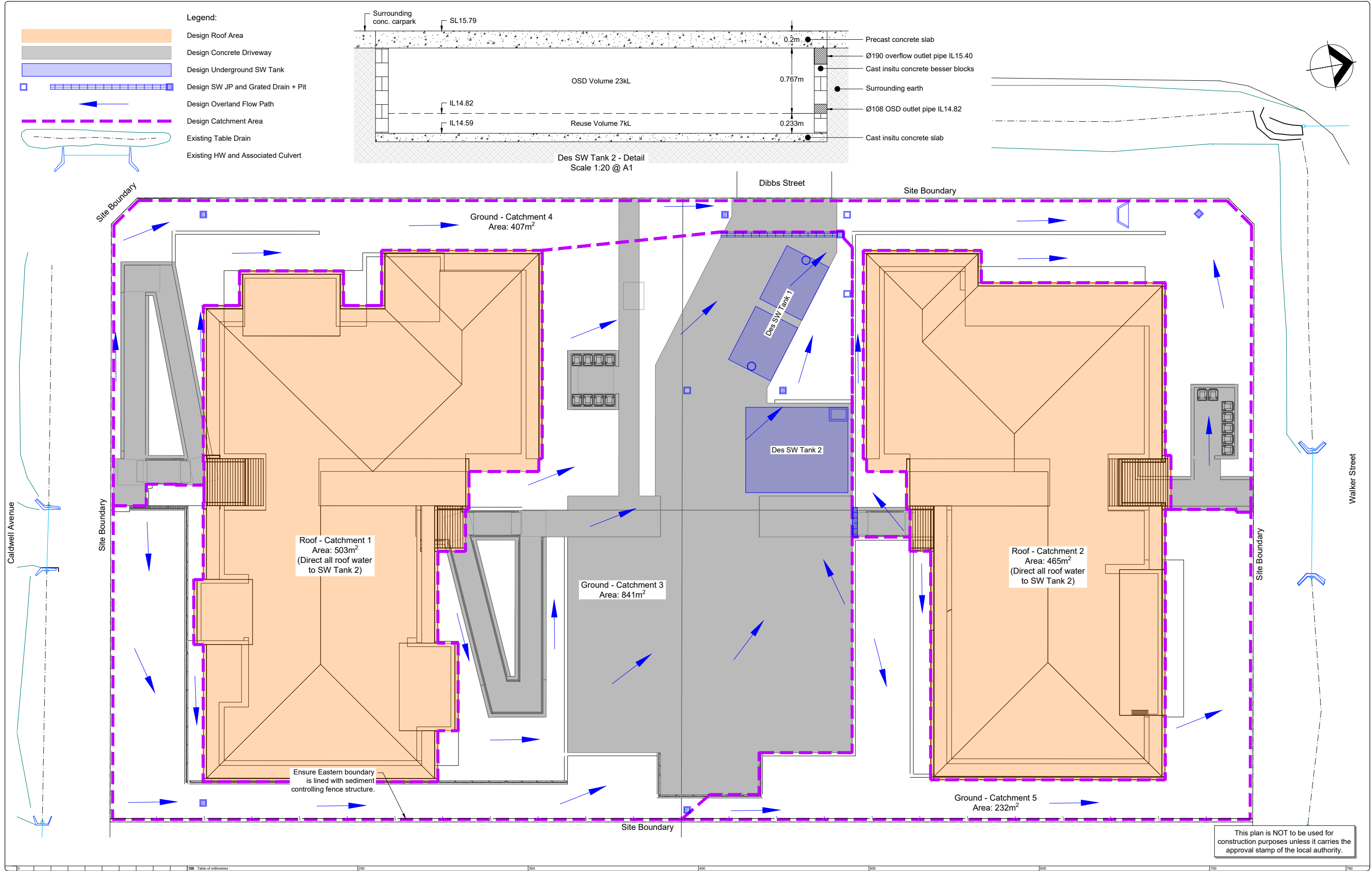

Issue	Date	Description	App'd
D	18/07/2023	Surface drainage structures and Sediment Fence	EMR
C	26/06/2023	SW Tank 1 Specification & Manhole inclusion	EMR
B	22/05/2023	Amended to suit LAHC comments	EMR
A	24/04/2023	Original Issue	RB

Client:

Level 4, 4 Parramatta Square,
Parramatta, NSW, 2150

Project:

1-3 Walker Street & 2-4 Caldwell Avenue
East Lismore, NSW 2480

Title:

**Stormwater Management Plan
SW Catchment Layout &
Des SW Tank 2 Detail**

Do not scale drawing. Use written dimensions only
This plan is copyright © All rights reserved.

ARDILL PAYNE
ENGINEERS PLANNERS SURVEYORS
ENVIRONMENTAL PROJECT MANAGEMENT

BALLINA 45 River Street Ph. 02 6686 3280
GUNNEDAH 285 Conadilly Street Ph. 02 6742 9955
A.B.N. 51 808 558 977 e-mail: info@ardillpayne.com.au



Design	RB/EMR	Scale	1:100 @ A1, 1:200 @ A3
Drawn	EMR		
Checked	RB	Datum	
Approved	RB	Drafting File	11467_SMP_2023-07-18.dwg
Date	24/04/2023	Design File	
Job No.	11467	Dwg No.	SMP02
		Issue	D

S:\01 Jobs\11400 - 11499\11467 Structures_ Walker St and Caldwell St.dwg, 19/07/2023 9:29:59 AM, AutoCAD PDF (General Documentation).pc3

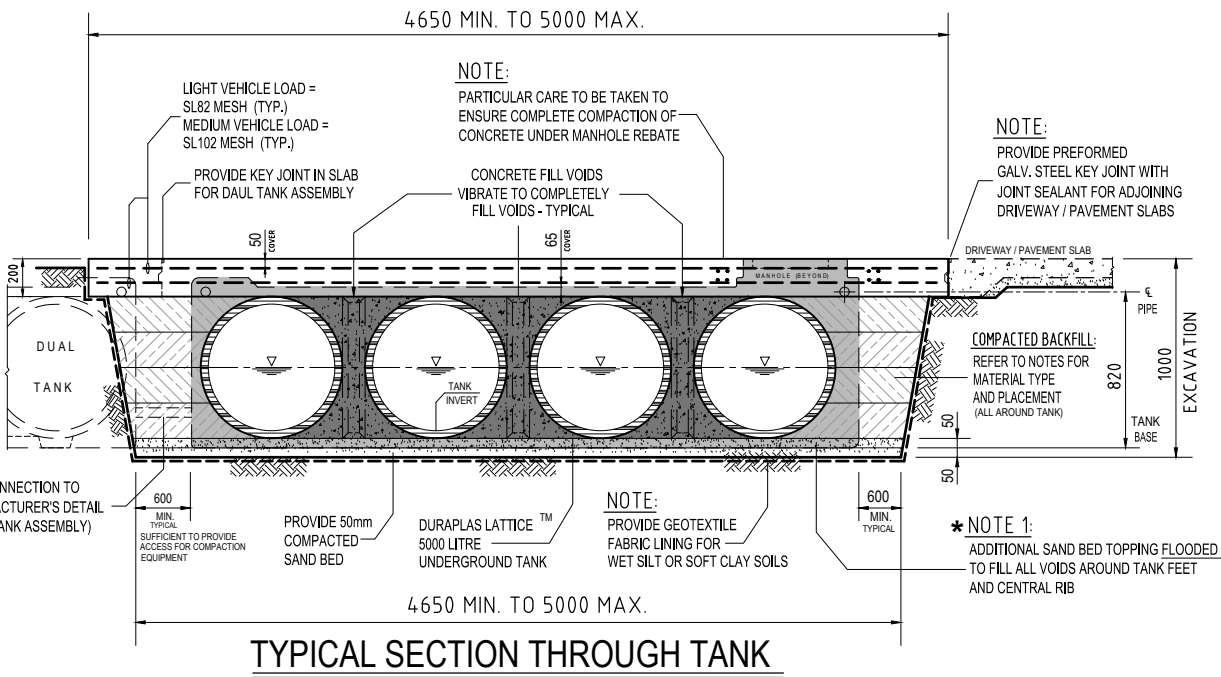

Please note, All Specifications and Details shown are taken from Duraplas website. Proposed Des SW tank 1 is two x Duraplas LU5000 Lattice (5kL) Underground Tanks (Under Driveway Model) as shown in SMP01 & SMP02. For any additional information, correspondence with Duraplas staff may be required.

LEGEND:

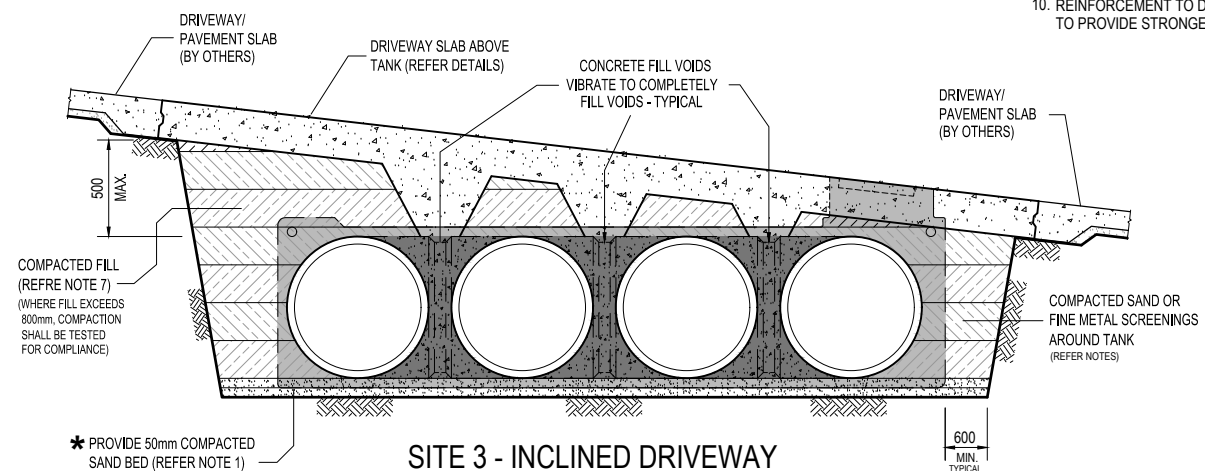
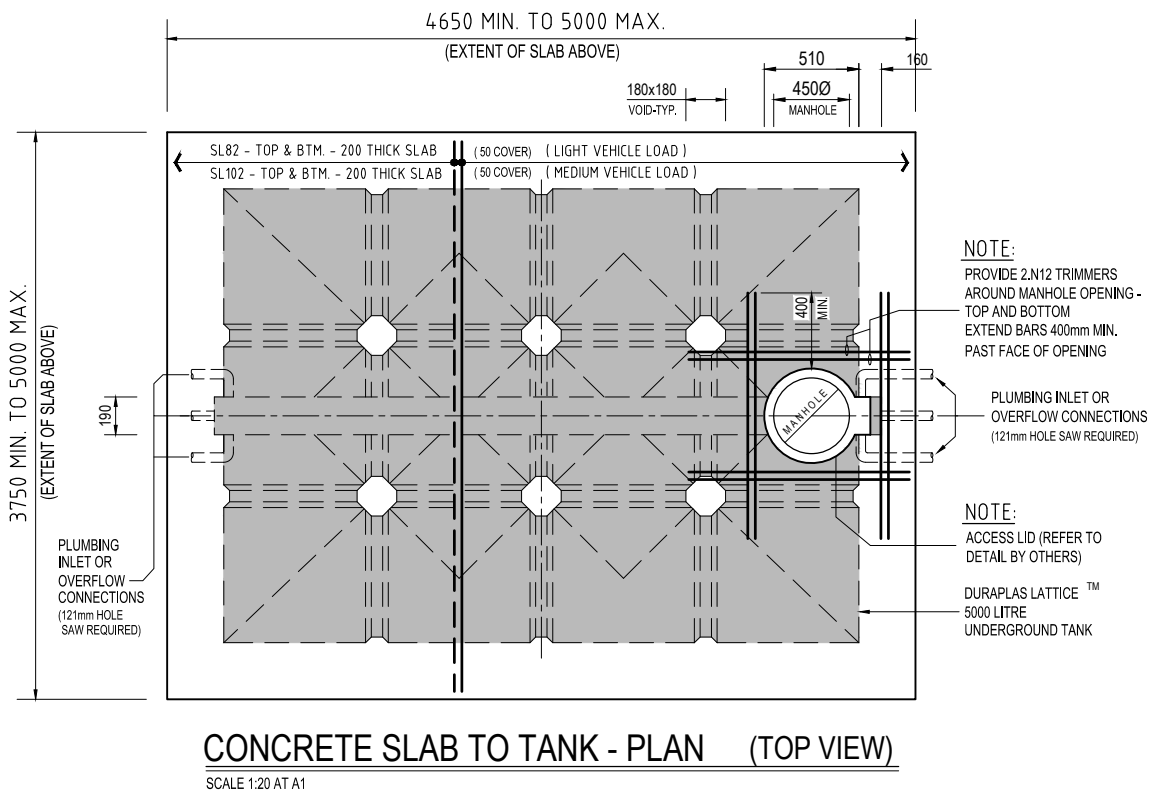
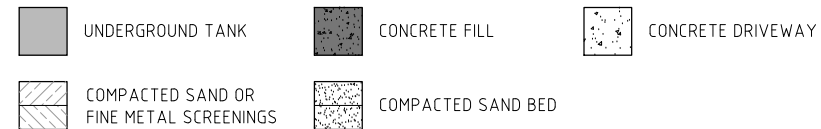

TYPICAL CONFORMING INSTALLATIONS

INSTALLATION NOTES:

- TANKS SHALL BE INSTALLED ON STABLE SITES WITH FOUNDATION MATERIAL FREE OF ORGANIC MATERIAL AND OF UNIFORM BEARING CAPACITY OF NOT LESS THAN 100 KPa.
- WHERE FOUNDATION CONDITIONS ARE UNKNOWN, THE TANK INSTALLATION SHALL BE SUBJECT TO A GEOTECHNICAL ENGINEERING ASSESSMENT. FOR NON-CONFORMING SITES AND/OR LOADING SITUATIONS, INSTALLATION SHALL BE ASSESSED BY A STRUCTURAL ENGINEER.
- EXCAVATIONS TO BE FREE OF WATER BEFORE CONCRETING.
- ALL WORKMANSHIP AND MATERIALS SHALL BE IN ACCORDANCE WITH CURRENT AUSTRALIAN STANDARDS INCLUDING AS. 3600 "CONCRETE STRUCTURES" ALSO BCA AND LOCAL COUNCIL REQUIREMENTS.
- CONCRETE QUALITY:**
 - CONCRETE TO BE MINIMUM GRADE N25 (25 MPa).
 - 80mm SLUMP.
 - 20mm MAXIMUM AGGREGATE.
- DESIGN LOADING - SITE 2 OR 3:** (AS/NZS 1170.1 : 2002)
 - LIGHT VEHICLE TRAFFIC:**
VEHICLES NOT EXCEEDING 2500Kg. GROSS MASS.
 - MAXIMUM VEHICLE TRAFFIC:**
VEHICLES NOT EXCEEDING 10000Kg. GROSS MASS.
- BACKFILL:**
 - MATERIALS:**
 - LIGHT VEHICLE TRAFFIC:** CLEAN GRANULAR FILL (EG. SAND OR FINE METAL SCREENINGS)
 - MEDIUM VEHICLE TRAFFIC:** CEMENT STABILIZED SAND [1(c) : 6(s) DRY HAND MIX] [1(c) : 16(s) PREMIXED TRUCK DELIVERED]
 - PLACEMENT:**
FILL TANK WITH CLEAN WATER.
PLACE BACKFILL IN 200mm MAX. LAYERS EVENLY AROUND TANK PERIMETER TAKING CARE TO FILL ALL VOIDS, AND COMPACT AS "CONTROLLED FILL" IN ACCORDANCE WITH AS 2870. EACH LAYER TO BE COMPACTED WITH A VIBRATING PLATE OR ROLLER. FILL SHALL BE COMPACTED TO ACHIEVE A DENSITY INDEX NOT LESS THAN 65%. WHERE DEPTH OF FILL EXCEEDS 800mm COMPACTION SHALL BE TESTED FOR COMPLIANCE.
- CONCRETE PLACEMENT:**
 - POUR CONCRETE THROUGH CENTRE CORES AND VIBRATE TO ENSURE CONCRETE DISTRIBUTION AND ELIMINATE VOIDS.
 - MAINTAIN REINFORCEMENT COVER DURING POUR.
 - PROVIDE NON-SLIP FINISH TO TRAFFICABLE SURFACE.
- LAP TO REINFORCING FABRIC:**
LAPS AND SPLICES TO REINFORCEMENT SHALL BE MADE ONLY IN THE POSITIONS AND TO THE DIMENSIONS SHOWN. TYPICAL FABRIC LAP, UNLESS NOTED OTHERWISE:

25
225
MIN. LAP WITH CROSS WIRES
- REINFORCEMENT TO DRIVEWAY SLAB MAY BE INCREASED TO PROVIDE STRONGER CONTROL ON SHRINKAGE CRACKING.

This plan is NOT to be used for construction purposes unless it carries the approval stamp of the local authority.

Issue	Date	Description	App'd
D	18/07/2023	Surface drainage structures and Sediment Fence	EMR
C	26/06/2023	SW Tank 1 Specification & Manhole inclusion	EMR
B	22/05/2023	Amended to suit LAHC comments	EMR
A	24/04/2023	Original Issue	RB

Client:



Level 4, 4 Parramatta Square,
Parramatta, NSW, 2150

Project:

1-3 Walker Street & 2-4 Caldwell Avenue

East Lismore, NSW 2480

Title:

Des SW Tank 1 - Duraplas Specification
Duraplas LU5000 Lattice (5kL)
Underground Tank (Under Dway Model)

Do not scale drawing. Use written dimensions only
This plan is copyright © All rights reserved.

ARDILL PAYNE

ENGINEERS PLANNERS SURVEYORS
ENVIRONMENTAL PROJECT MANAGEMENT
BALLINA 45 River Street Ph. 02 6686 3280
GUNNEDAH 285 Conadilly Street Ph. 02 6742 9955
A.B.N. 51 808 558 977 e-mail: info@ardillpayne.com.au



Design	RB/EMR	Scale	1:100 @ A1, 1:200 @ A3
Drawn	EMR		
Checked	RB	Datum	
Approved	RB	Drafting File	11467_SMP_2023-07-18.dwg
Date	24/04/2023	Design File	
Job No.	11467	Dwg No.	SMP03
Issue			D

S:\01 Jobs\11400 - 11499\11467 Structures_ Walker St and Caldwell St_East Lismore\05 Drawings\01 Civil\01 Current\11467_E&SC_2023-07-18.dwg, 19/07/2023 9:35:17 AM, AutoCAD PDF (General Documentation).pc3

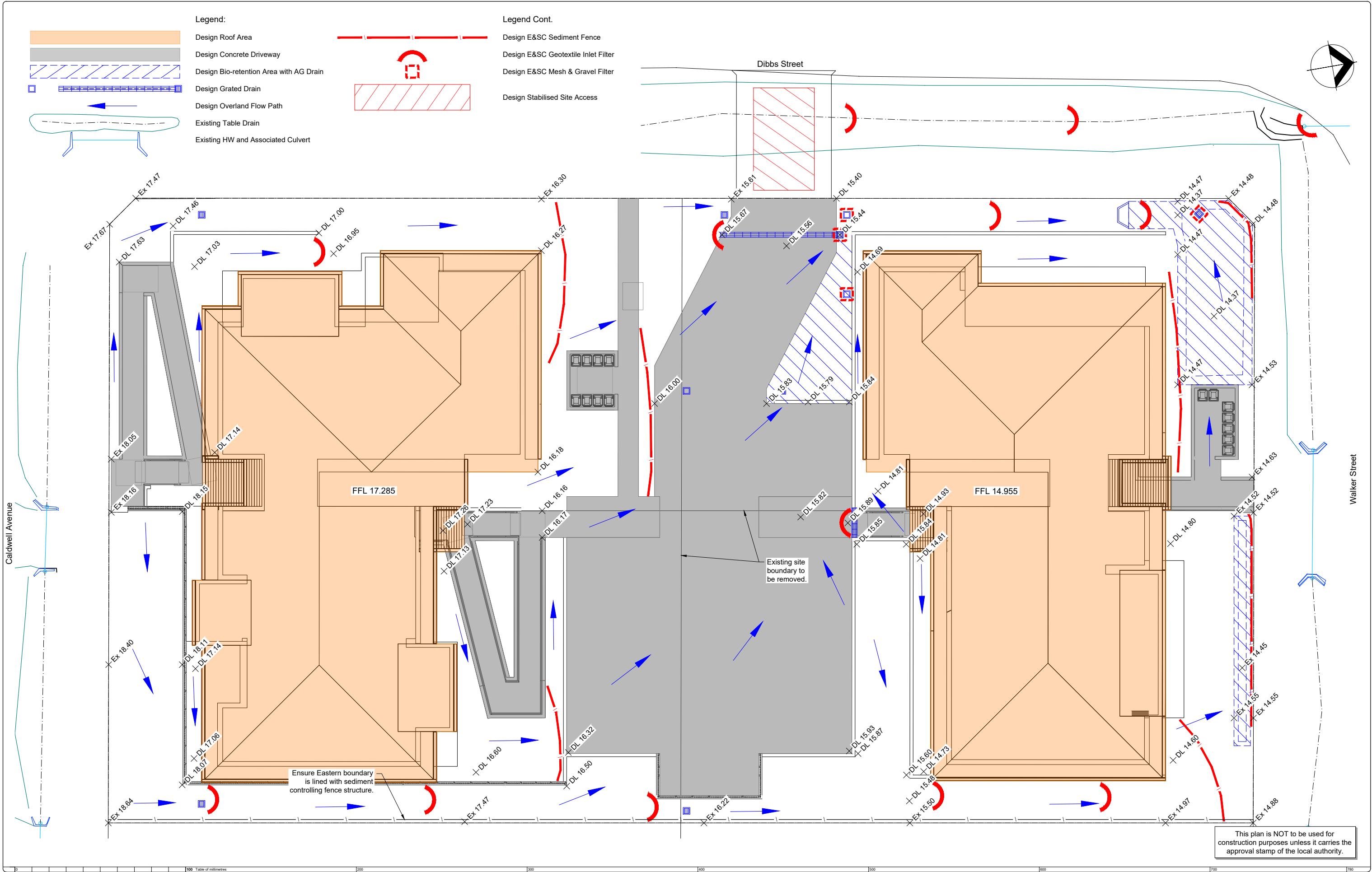

This plan is NOT to be used for construction purposes unless it carries the approval stamp of the local authority.

Issue	Date	Description	App'd
C	18/07/2023	Surface drainage structures and Sediment Fence	EMR
B	22/05/2023	Amended to suit LAHC comments	EMR
A	24/04/2023	Original Issue	RB

Client:



Level 4, 4 Parramatta Square,
Parramatta, NSW, 2150

Project:

1-3 Walker Street & 2-4 Caldwell Avenue

East Lismore, NSW 2480

Title:

Erosion & Sediment Control Layout Plan

Do not scale drawing. Use written dimensions only
This plan is copyright © All rights reserved.

ARDILL PAYNE
& PARTNERS
ENGINEERS PLANNERS SURVEYORS
ENVIRONMENTAL PROJECT MANAGEMENT

BALLINA 45 River Street Ph. 02 6686 3280
GUNNEDAH 285 Conadilly Street Ph. 02 6742 9955
A.B.N. 51 808 558 977 e-mail: info@ardillpayne.com.au



Design	RB/EMR	Scale	1:100 @ A1, 1:200 @ A3
Drawn	EMR		
Checked	RB	Datum	
Approved	RB	Drafting File	11467_E&SC_2023-07-18.dwg
Date	24/04/2023	Design File	
Job No	11467	Dwg No.	ESC01
		Issue	C

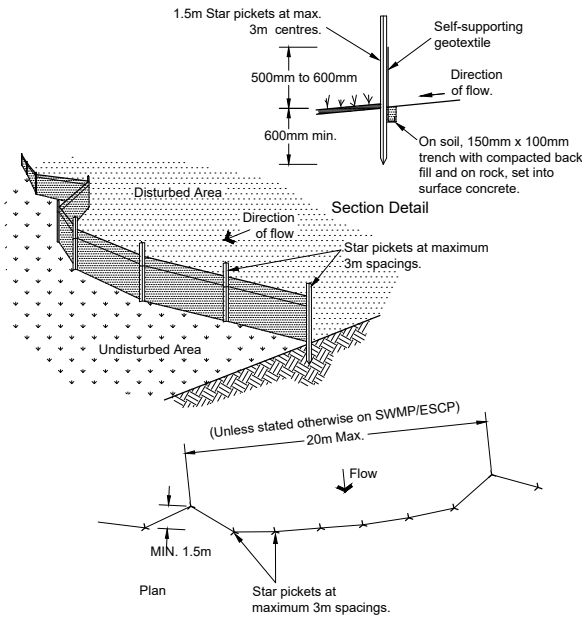

Construction Notes:

1. Construct sediment fence as close as possible to parallel to the contours of the site.
2. Drive 1.5 metre long star pickets into ground, 3 metres apart.
3. Dig a 150mm deep trench along the upslope line of the fence for the bottom of the fabric to be entrenched.
4. Backfill trench over base of fabric.
5. Fix self-supporting geotextile to upslope side of post with wire ties or as recommended by geotextile manufacturer.
6. Join sections of fabric at support post with a 150mm overlap.

Sediment Fence

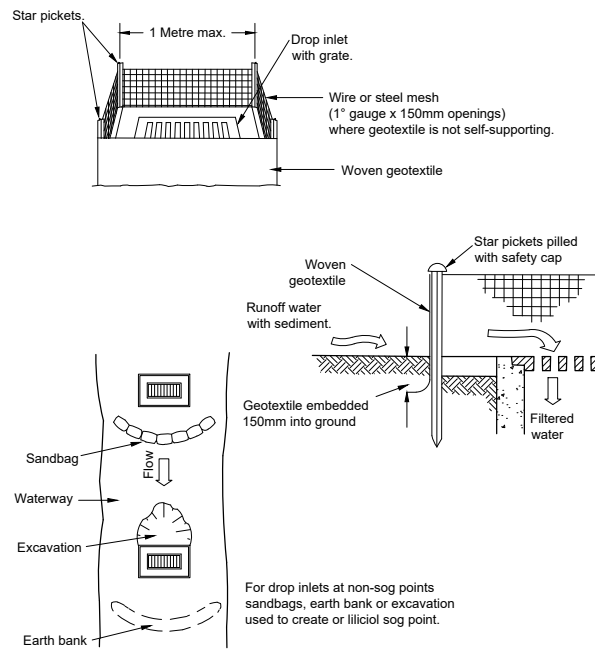

Construction Notes:

1. Fabricate a sediment barrier made from geotextile or straw bales.
2. Support geotextile with mesh tied to posts at 1 metre centres.
3. Do not cover inlet with geotextile.

Geotextile Inlet Filter

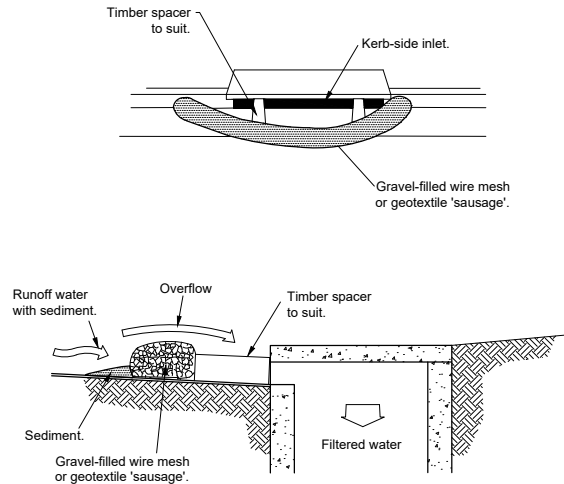

Note: This practise only to be used where specified in an aproved SWMP/ESCP.

Construction Notes:

1. Fabricate a sleeve made from geotextile or wire mesh longer than the length of the inlet pit.
2. Fill the sleeve with 25mm to 50mm gravel.
3. Form an elliptical cross-section about 150mm high x 400mm wide.
4. Place filter at the opening of the kerb inlet leaving a 100mm gap at the top to act as an emergency spillway.
5. Maintain the opening with the sapcer blocks.
6. Form a seal with the kerbing and prevent sediment bypassing the filter.
7. Fit to all kerb inlets at sag point.

Mesh and Gravel Inlet Filter

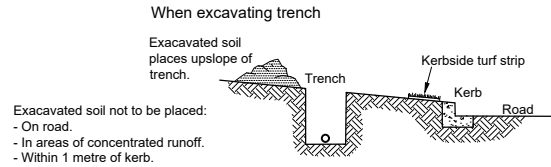

When backfilling trench

Trench backfilled, compacted to 95 per cent standard compaction, topsoiled, levelled and topped up as necessary should subsidence occur.

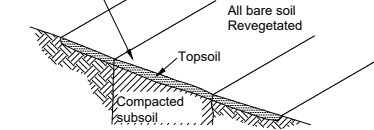

On steep and/or long sections of trench

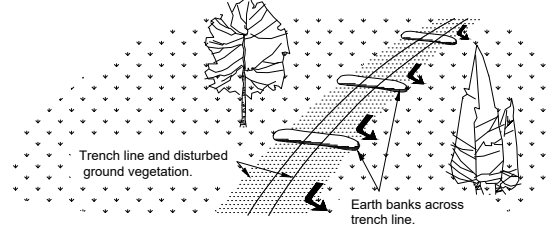

Construction Notes:

1. Do not open any trench unless it is likely to be closed in three days.
2. Place excavated material upslope of trench.
3. Stockpile topsoil separately from subsoil.
4. Divert runoff from the line of the cut with diversions.
5. Rehabilitate in accordance with the specification.

Utility Construction

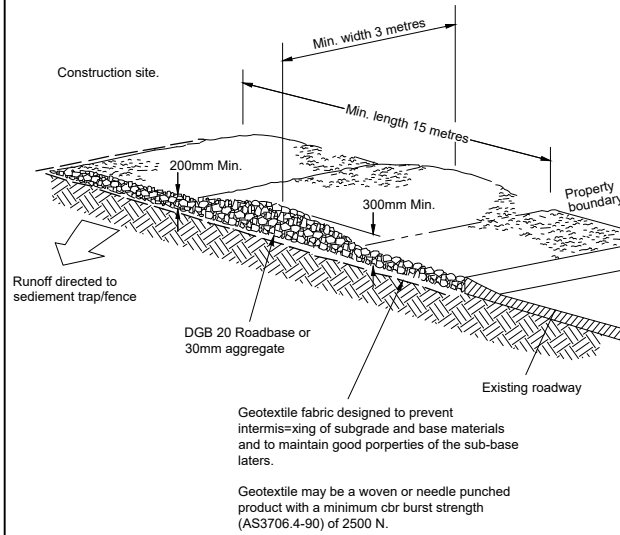

Construction Notes:

1. Strip topsoil and level site.
2. Compact subgrade.
3. Cover are with needle punched geotextile.
4. Construct 200mm thich pad over geotextile using roadbase or 30mm aggregate. Minimum length 15 metres or to building alignment. minimum width 3 metres.
5. Construct hump immediately within boundary to divert water to a sediment fence or other sediment trap.

Stabilised Site Access

This plan is NOT to be used for construction purposes unless it carries the approval stamp of the local authority.

Issue	Date	Description	App'd
C	18/07/2023	Surface drainage structures and Sediment Fence	EMR
B	22/05/2023	Amended to suit LAHC comments	EMR
A	24/04/2023	Original Issue	RB

Client:



Level 4, 4 Parramatta Square,
Parramatta, NSW, 2150

Project:

1-3 Walker Street & 2-4 Caldwell Avenue

East Lismore, NSW 2480

Title:

Erosion & Sediment Control Details

Do not scale drawing. Use written dimensions only
This plan is copyright © All rights reserved.

ARDILL PAYNE

& p a r t n e r s

ENGINEERS PLANNERS SURVEYORS

ENVIRONMENTAL PROJECT MANAGEMENT

BALLINA 45 River Street Ph. 02 6686 3280

GUNNEDAH 285 Conadilly Street Ph. 02 6742 9955

A.B.N. 51 808 558 977 e-mail: info@ardillpayne.com.au



Design	RB/EMR	Scale	1:100 @ A1, 1:200 @ A3
Drawn	EMR		
Checked	RB	Datum	
Approved	RB	Drafting File	11467_E&SC_2023-07-18.dwg
Date	24/04/2023	Design File	
Job No	11467	Dwg No.	ESC02
		Issue	C